

# MOBEYE INTERNET PORTAL

Mobeye CM2400/CM2410 with extended functionality



Mobeye units are prepared for both 'stand alone' use as in combination with the Internet Portal. It's your choice. Please read more about the two possibilities.

## Stand-alone vs Mobeye Internet Portal

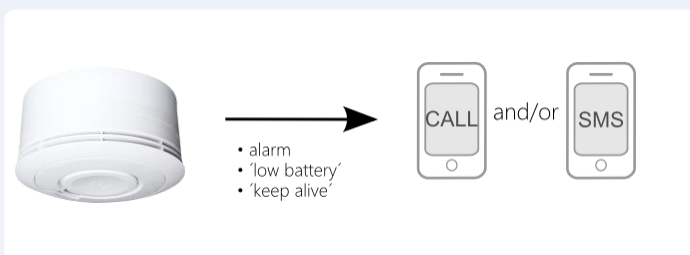

### Stand-alone

Any SIM card can be placed in the Mobeye unit. This can be prepaid or postpaid. After an alarm event, the Mobeye notifies the preset numbers per SMS text message and/or call. Test messages and low battery warnings are received per SMS.

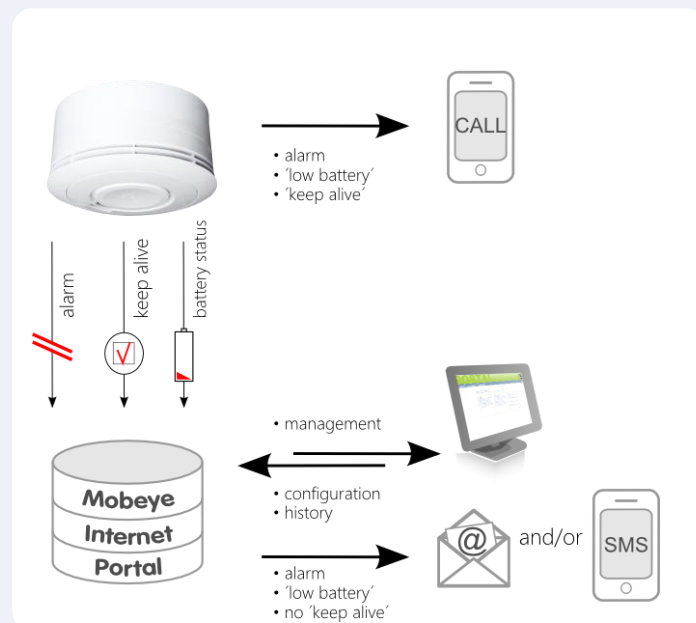

### Mobeye Internet Portal

The Mobeye CM2400 can be registered on Mobeye Internet Portal. In addition to the stand-alone functions, it offers additional functionality:

#### Additional information

- Management of device name and location
- Display of historical events

#### Additional functions

- Programming via internet
- Alarming via e-mail, SMS and call
- Notification when the 'keep alive' message was not received by the portal
- SMS or e-mail at low batteries
- Distinction between technical alerts and alarm messages

## SIM card

To register the Mobeye unit in the Portal, a Mobeye SIM card is necessary. The contract is activated online. The Mobeye SIM is a roaming card, which means that you are assured of a strong and stable network. If the network fails, the unit will automatically switch over to another network. Security. Anywhere, anytime! The card has a flat fee rate for Europe.