

MOBEYE POWERGUARD

Mobeye GSM Power Failure Alarm CM2100



Being notified on power failure with Mobeye alarm module

Is the availability of power supply important to you? The Mobeye PowerGuard reports power outages via telephone call and SMS message. The Mobeye PowerGuard has two additional inputs. By connecting devices or external sensors it can monitor much more, such as the operation of your machine or several values via the sensors.



The Mobeye PowerGuard is used to inform a maximum of five alarm number via SMS text messages and/or audio call using the integrated GSM module. 'Confirmation' by the receiver will ensure that the other contacts no longer receive calls.

By simply plugging the mains adapter into an AC outlet, the power supply is monitored. Alternatively any other 12VDC power supply can be used. The detector is equipped with batteries, which take over the functions during a power failure. Next it will operate in the 'low power status' to save the batteries. All messages, such as an alarm notification, 'keep alive' messages and the 'low battery voltage' SMS text message will still be sent.

Several settings can be programmed easily, like alarm delays on the power failure, alarm delays for the inputs, user defined alarm texts etc. Mains adapter and batteries are included. The PowerGuard only needs a SIM card needed, from any provider.

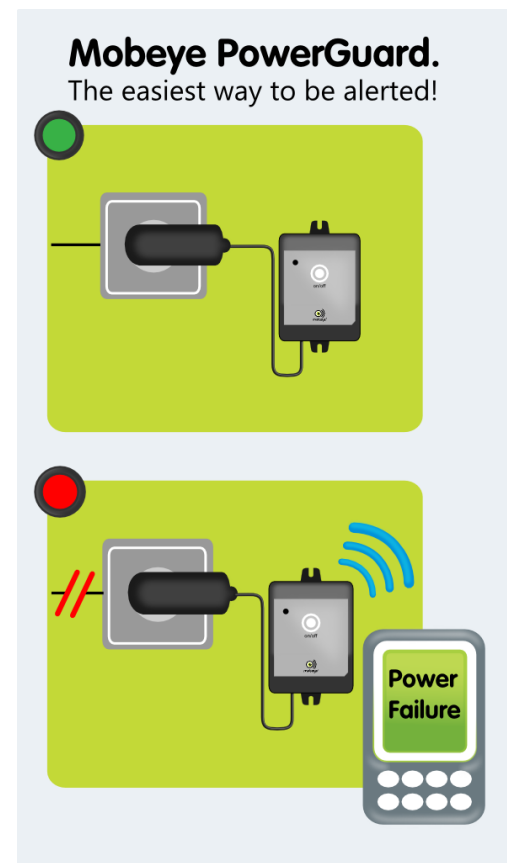

Mobeye Internet Portal & SIM service

The Mobeye CM2100 can be deployed 'stand-alone', using a regular SIM card. Optional is the connection with the Mobeye Internet Portal using a Mobeye SIM card. It unlocks many more features, such as programming via internet. The portal distinguishes between alarm messages and technical reports. The contacts receive messages per call, SMS and / or email. The "keep-alive" monitor provides additional security by monitoring test reports. If the test message are not sent in time, the (technical) contacts receive a warning message from the portal.



About Mobeye

The company Mobeye is specialized in high quality GSM/GPRS alarm and telemetry technology. Mobeye products are characterised by configuration flexibility, user friendliness and an extremely low power consumption. Mobeye aims to design and market products that contribute to a safer world for its customers.

Mobeye PowerGuard Technical data	
Inputs	<ul style="list-style-type: none"> • 2 dry contacts (NO or NC) • 12VDC (optional: mains adapter)
User interface	<ul style="list-style-type: none"> • Switch button • 1x status LEDs
Dimensions	<ul style="list-style-type: none"> • 80 * 60 * 40 mm
(Alarm) messages	<ul style="list-style-type: none"> • SMS and/or call at activation of an input <i>Confirmation possible by receiver of phone call, after which subsequent calls are stopped</i> • SMS and/or call at power failure • SMS at power restoration • SMS at low batteries • SMS test messages ("keep alive")
Reports	<ul style="list-style-type: none"> • Status reports, settings report and GSM network strength at request via SMS text messages
Security	<ul style="list-style-type: none"> • PIN code security for configuration
Configuration	<ul style="list-style-type: none"> • Via SMS text message: <ul style="list-style-type: none"> • telephone numbers (max. 5) • identification and alarm texts • alarm delay times • input as NO or NC • alarm repeat times • automatic arming and disarming schemes <i>two schemes possible, which can be assigned to days of the week</i> • locking of on/off button possible • frequency of test messages
Power supply	<ul style="list-style-type: none"> • 2 * CR123 lithium (included) or • 12VDC (mains adapter) + 2 * CR123
Battery life time	<ul style="list-style-type: none"> • > 1 year at normal use (battery operated) • > 2 years at normal use (ext. power supply)
GSM/GPRS	<ul style="list-style-type: none"> • Quad band EGSM 900/1800 - 850/1900 MHz

